

1 2 3 4 5 6 7 8 9 10 11 12 13 14 15 16 17

A
B
C
D
E
F
G

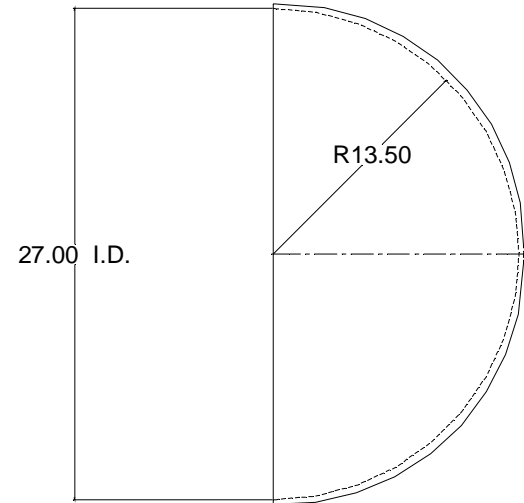
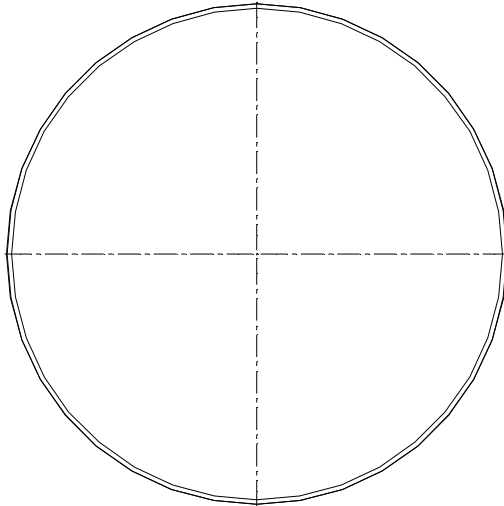
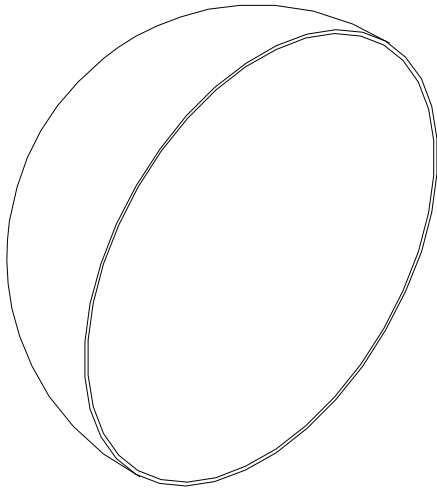

NO STRAIGHT WALL

Notes:

1. Finished material thickness can range from 0.030" to 0.125" depending upon customer requirement.
2. Parts formed on Toledo Metal Spinning Company tooling.
3. One piece constuction.
4. Optional outside brushed finish available on request.



TOLEDO METAL SPINNING COMPANY
 1819 Clinton Street, Toledo, OH 43607
 Tel:(419)535-5931 Fax:(419)535-0565
www.toledometal spinning.com

P/N: HM2700-0000

Material: Aluminum, Mild Steel

Parent Metal Thickness: .060" to .125"

Dwg#: HM2700-0000.dwg

Desc: Hemisphere

Date: 04/22/08

Page: 1/1

Drawn By: DHG

Unless otherwise specified

1. Tolerances:
- | | |
|------------|---------------|
| X. ±0.25 | X.XXX ±0.005 |
| X.X ±0.12 | X.XXXX ±0.001 |
| X.XX ±0.03 | Ang. ±0.25 |
- (X.XXX) Reference

2. All dimensions are in inches
3. Break all edges with R1/32"